

Notes:
Approval/Particulars on the information shown should be obtained prior to being used as a basis for any contract.

Drawing based on Ordnance Survey data and is subject to a full line & level survey.

This drawing has been prepared subject to the following:

1. Planning Approval
2. Building Regulation & Fire Officers Approval
3. Fire Officers Approval
4. Highways Approval
5. Enquiries on location of Statutory Utilities services & equipment.

Contractors to check dimensions and notify any discrepancies or errors to the company immediately.

Work to figured dimensions only. Do not scale.

© All Rights Reserved.

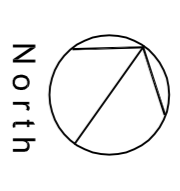

North

- Parking Includes 395 total spaces
- 22 disabled
- 12 Parent & Toddler

To be read in conjunction with midland tree surgeons dwg. 01-tree constraints plan (trees to be removed shown dashed)

KEY

T = NEW TREE

E = NEW EVERGREEN TREE

C = ELECTRIC CHARGE POINT

--- STRUCTURE TO CAR DECK RAMP

▨ ADDITIONAL LANDSCAPING ZONE

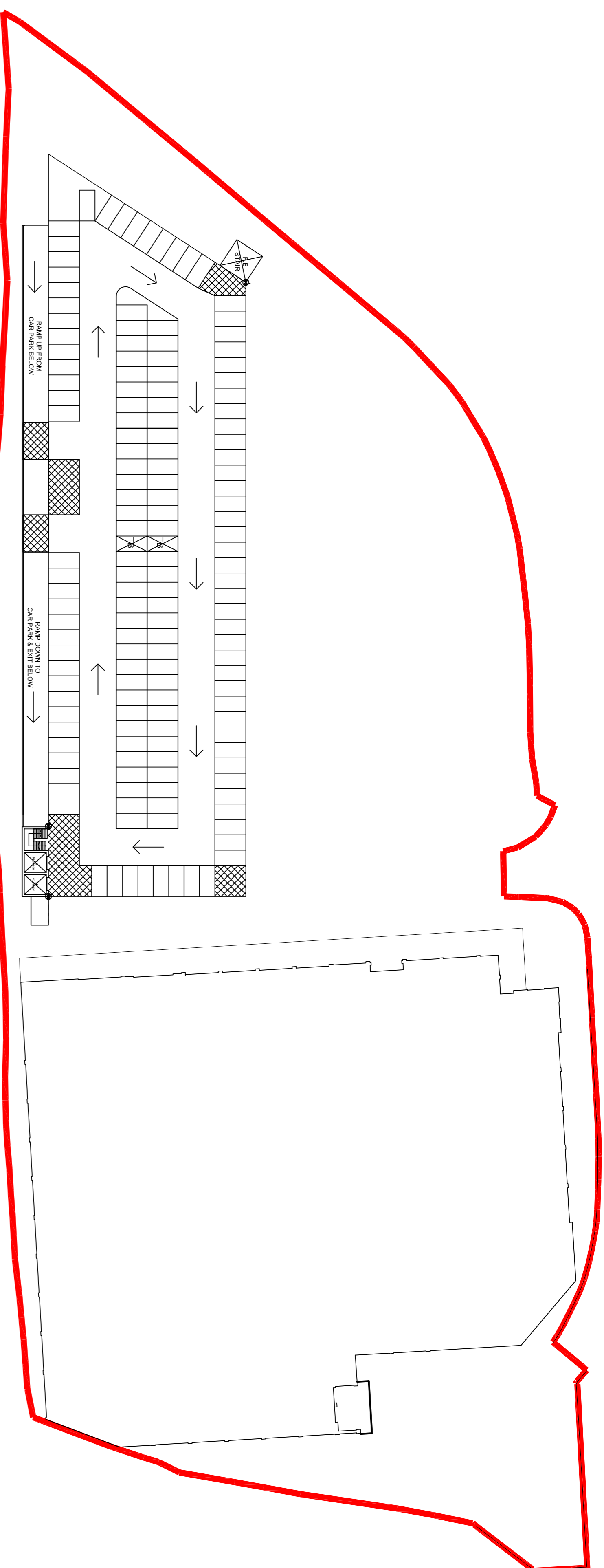

Proposed Site Plan Upper Deck
149 no car parking spaces

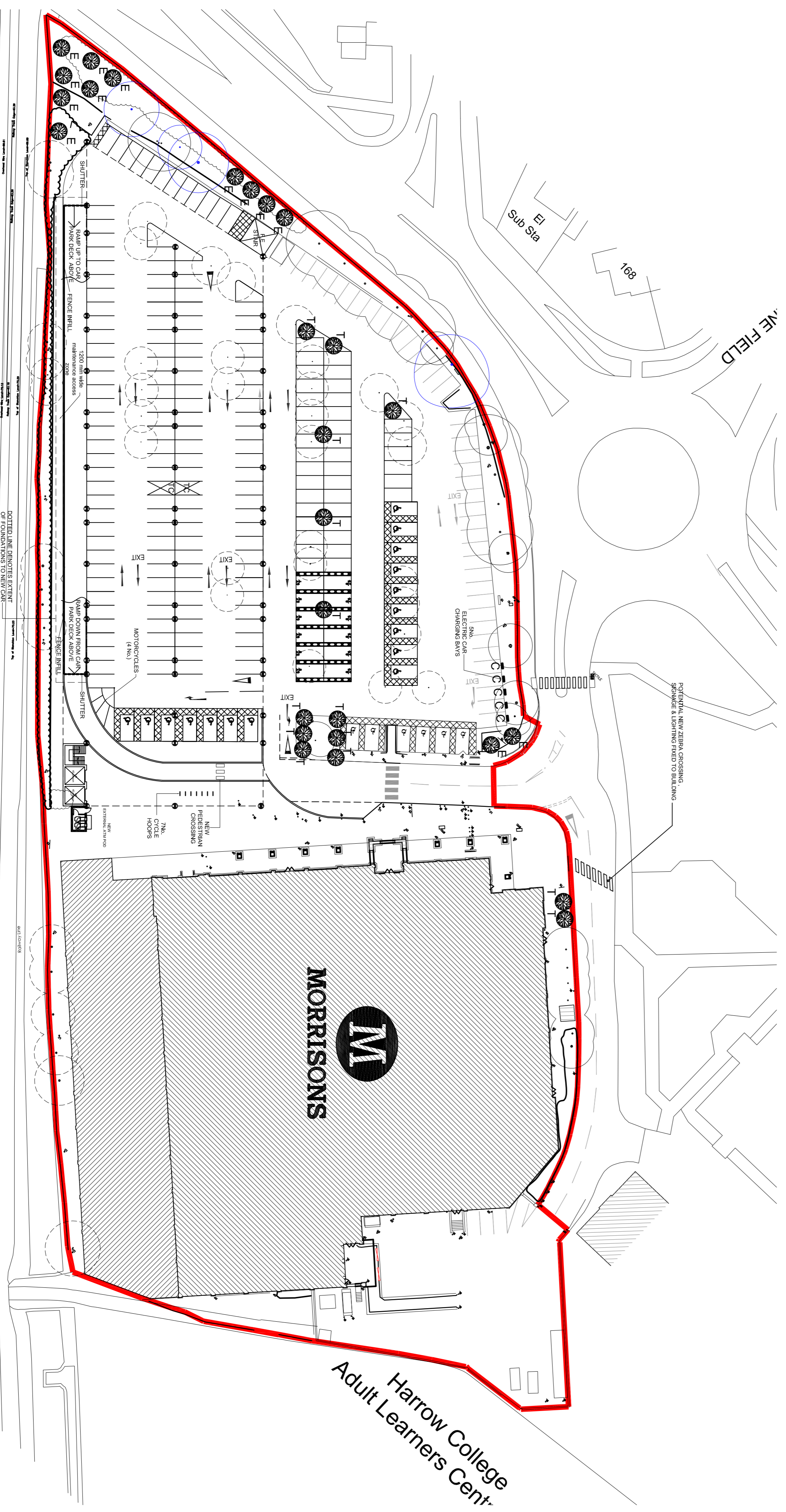

Proposed Site Plan Ground Level
246 no car parking spaces



1:500

Rev.	Date	Description	Drawn	Checked
C	07/02/13	New trees between parking deck and railway removed	LC	-
B	19/12/12	Electric charge points, trees, foundation extent, motorcycle parking	PGW	-
A	19/12/12	Shutters & fencing added to bottom of ramps. Potential new zebras crossing indicated	LC	-

Client:	MORRISON'S
Project:	Wm Morrison Supermarkets Plc Proposed Extension 299 Uxbridge Road Hatch End HA5 4QT
Title:	Proposed Site Plan

Drawn	LC	Checked	
Date	July/12	Scale	1:500@A1
Status	Planning	Draw No.	12286 - PA - 50
		Rev.	C

DAVIS WEATHERILL PARTNERSHIP CHARTERED ARCHITECTS	DAVIS WEATHERILL PARTNERSHIP CHARTERED ARCHITECTS
Halsborne Court 67-69 Heddon Rd Birmingham T: 0121 466 9234 F: 0121 466 2232 davisweatherill.co.uk	The Arch Barn Unit 7B, Emsay Yard Leeds T: 0113 288 8106 F: 0113 288 8787 davisweatherill.co.uk
Contact: Birmingham Office	Contact: Leeds Office
www.davisweatherill.co.uk	